



Pressure regulator

- Qn = 1050-1070 l/min
- standard ISO 5599-1
- Frame size ISO 2
- Controlled port 1 2 2, 4

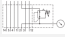

Working pressure min./max.	12 bar
Adjustment range min./max.	0,5 ... 8 bar
Ambient temperature min./max.	-15 ... 50 °C
Medium	Compressed air
Max. particle size	5 µm
Oil content of compressed air	0 ... 5 mg/m³
Tightening torque for mounting screws	5 Nm
Weight	See table below
The delivered product may vary from that in the illustration.	

Technical data

Part No.		Frame size	Flow	Controlled port	Weight
			Qn		
R422103092		ISO 2	1050 l/min	1	1 kg
R422103093		ISO 2	1070 l/min	2	1,11 kg
R422103094		ISO 2	1070 l/min	2, 4	1,6 kg
R422103095		ISO 2	1050 l/min	1	1 kg

Scope of delivery incl. seal and mounting screws, Order pressure gauge separately, Nominal flow Qn at 6 bar and Δp = 1 bar .

Technical information

Material	
Housing	Aluminum
Seals	Butadiene rubber

Dimensions

Dimensions

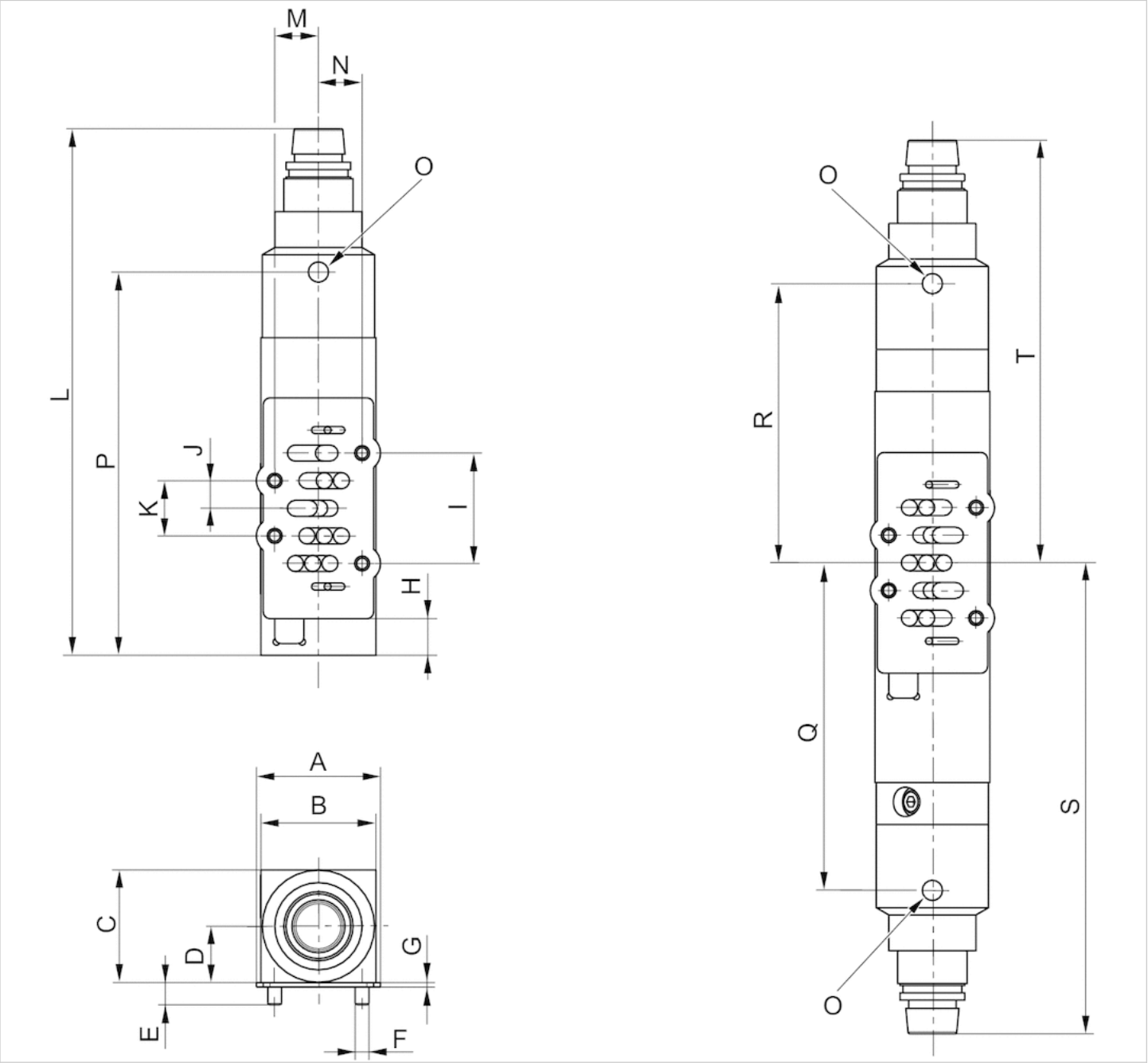

Dimensions

Part No.	A	B	C	D	E	F	G	H	I	J	K	L	M	N	O	P	Q	R
R422103092	54	50	48.90	24.45	9.70	M6	2	15.90	48	12	24	228.90	19	19	G 1/8	166.58	-	-
R422103093	54	50	48.90	24.45	9.70	M6	2	15.90	48	12	24	247.20	19	19	G 1/8	183.84	-	-
R422103094	54	50	48.90	24.45	9.70	M6	2	-	48	12	24	-	19	19	G 1/8	-	142.34	121.34
R422103095	54	50	48.90	24.45	9.70	M6	2	-	48	12	24	-	19	19	G 1/8	-	-	-

S	T
-	-
-	-

S	T
204.66	183.66
–	–

Efficient pneumatic solutions, our program: cylinders and drives, valves and valve systems, air supply management



Visit us: [Emerson.com/Aventics](https://emerson.com/aventics)

Your local contact: [Emerson.com/contactus](https://emerson.com/contactus)



Emerson.com



Facebook.com/EmersonAutomationSolutions



LinkedIn.com/company/Emerson-Automation-Solutions



Twitter.com/EMR_Automation

An example configuration is depicted on the title page. The delivered product may thus vary from that in the illustration. Subject to change. This Document, as well as the data, specifications and other information set forth in it, are the exclusive property of AVENTICS GmbH. It may not be reproduced or given to third parties without its consent. Only use the AVENTICS products shown in industrial applications. Read the product documentation completely and carefully before using the product. Observe the applicable regulations and laws of the respective country. When integrating the product into applications, note the system manufacturer's specifications for safe use of the product. The data specified only serve to describe the product. No statements concerning a certain condition or suitability for a certain application can be derived from our information. The information given does not release the user from the obligation of own judgement and verification. It must be remembered that the products are subject to a natural process of wear and aging.

The Emerson logo is a trademark and service mark of Emerson Electric Co. Brand logotype are registered trademarks of one of the Emerson family of companies. All other marks are the property of their respective owners. © 2020 Emerson Electric Co. All rights reserved.
2020-12



CONSIDER IT SOLVED™