

Active carbon filter, Series AS1-FLA

- G 1/4
- Air supply right

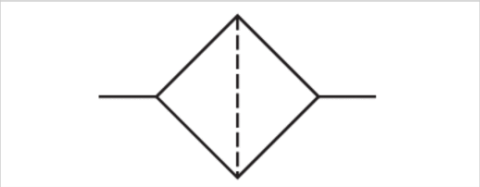

Type	Active carbon filter, Can be assembled into blocks
Parts	Active carbon filter
Mounting orientation	vertical
Working pressure min./max.	0 ... 12 bar
Ambient temperature min./max.	-10 ... 50 °C
Medium temperature min./max.	-10 ... 50 °C
Medium	Compressed air Neutral gases
Filter reservoir volume	12 cm³
Filter element	exchangeable
Weight	See table below

Technical data

Part No.	Port	Flow Qn	Version
R412014699	G 1/4	350 l/min	reservoir, polycarbonate, without protective guard
R412014700	G 1/4	350 l/min	reservoir, polycarbonate, with metal protective guard
R412014701	G 1/4	350 l/min	Metal reservoir without window

Part No.	Weight
R412014699	0,171 kg
R412014700	0,204 kg
R412014701	0,232 kg

Nominal flow Qn with secondary pressure p2 = 6 bar at Δp = 0.1 bar

Technical information

The pressure dew point must be at least 15 °C under ambient and medium temperature and may not exceed 3 °C .

Note: Polycarbonate reservoirs are susceptible to solvents, supplementary information can be found at "Customer information".

Recommended pre-filtering 0,01 μm

Max. achievable compressed air class acc. to ISO 8573-1:2010 - : - : 1

Technical information

Material	
Housing	Polyamide
Front plate	Acrylonitrile butadiene styrene
Seals	Acrylonitrile butadiene rubber
Threaded bushing	Die cast zinc
Reservoir	Polycarbonate metal
Protective guard	metal
Filter insert	Active carbon

Dimensions

Dimensions in mm

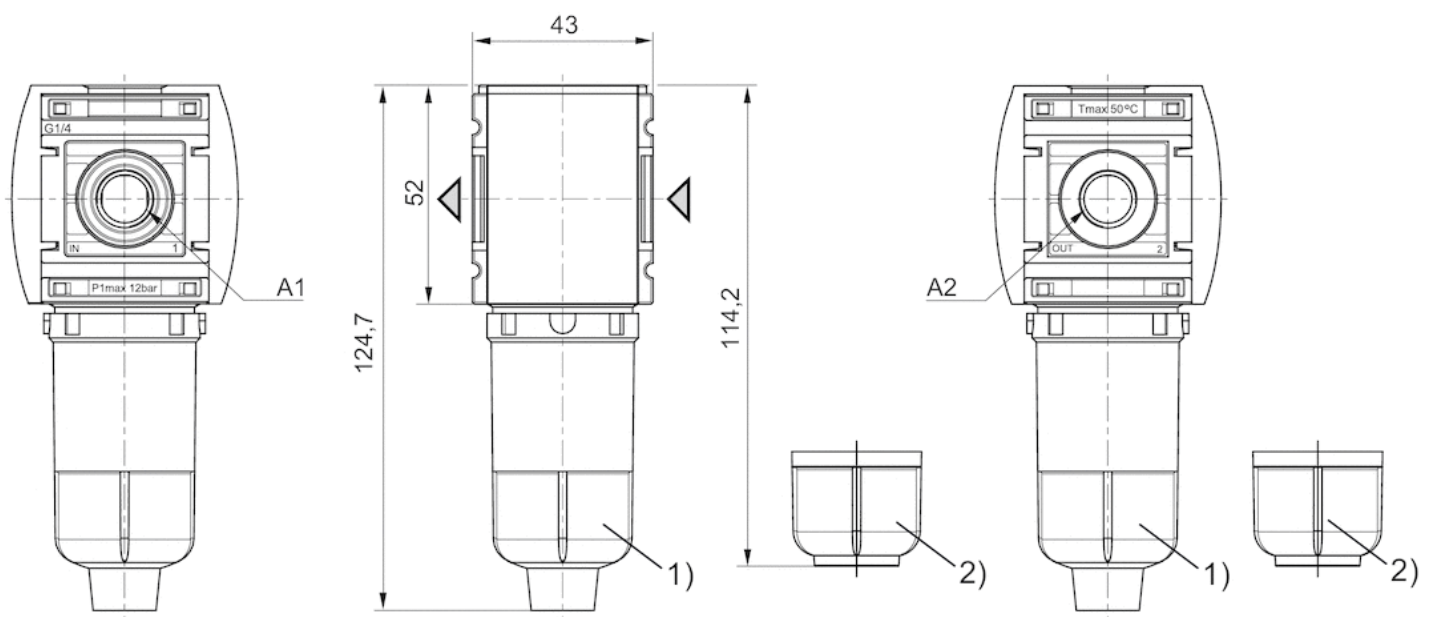

A1 = input

1) A2 = output

2) Reservoir: polycarbonate

Reservoir: metal

Diagrams

Flow rate characteristic

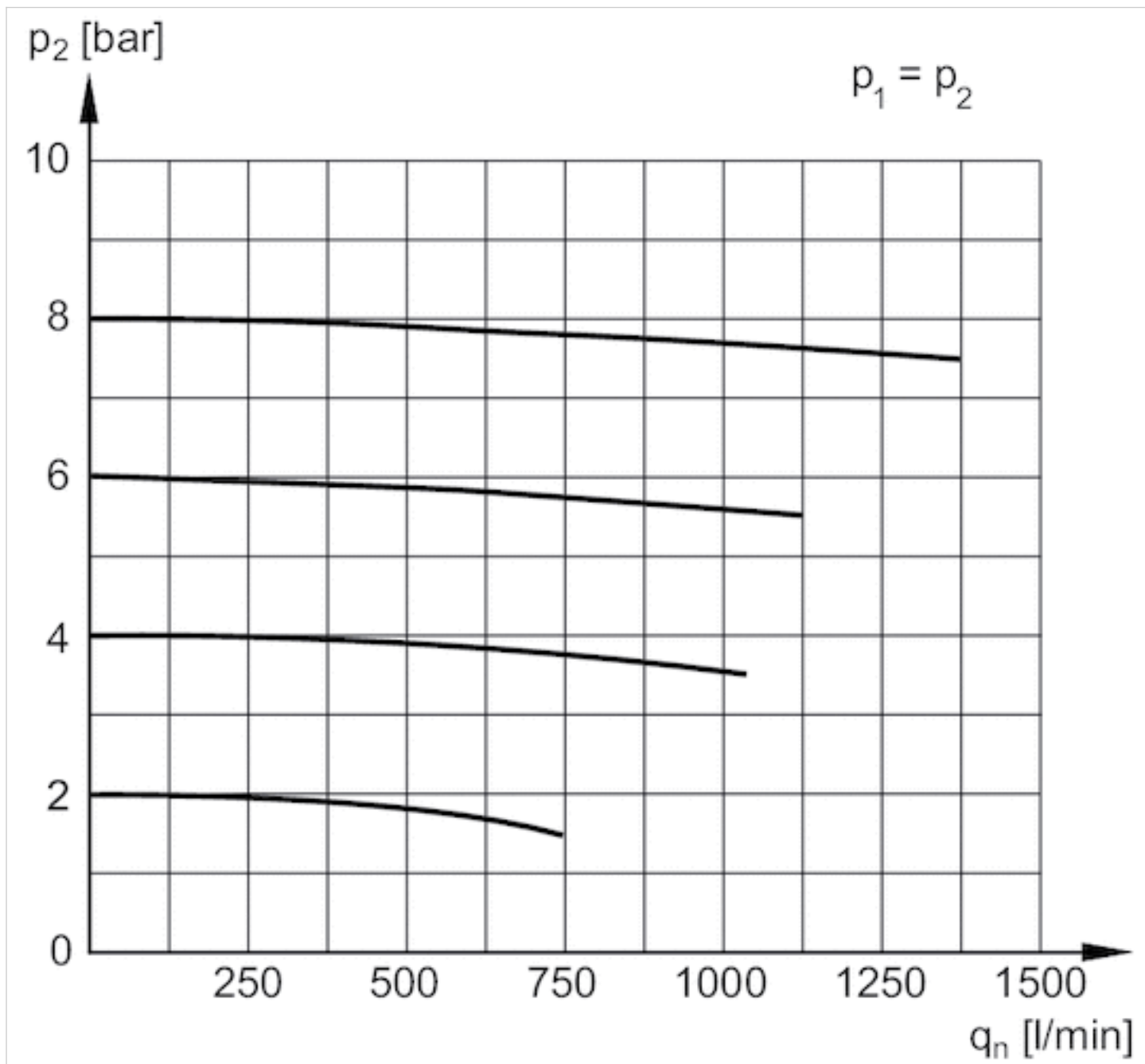

p_1 = working pressure
 p_2 = secondary pressure
 q_n = nominal flow

[illegible]

- 3 = Double nipple
4 = Key for E11 locking
6 = Transition plate DO30
7 = Adapter, Series CON-VP
8 = Mounting aid DO16, form C
9 = Mounting aid DO16, M12
10 = Adapter for external pilot air
11 = Adapter pneumatic operation
14 = Protective guard
15 = Transition plate for assembling a pressure gauge with connection thread G 1/8

Efficient pneumatic solutions, our program: cylinders and drives, valves and valve systems, air supply management



Visit us: [Emerson.com/Aventics](https://www.emerson.com/Aventics)

Your local contact: [Emerson.com/contactus](https://www.emerson.com/contactus)



Emerson.com



Facebook.com/EmersonAutomationSolutions



LinkedIn.com/company/Emerson-Automation-Solutions



Twitter.com/EMR_Automation

An example configuration is depicted on the title page. The delivered product may thus vary from that in the illustration. Subject to change. This Document, as well as the data, specifications and other information set forth in it, are the exclusive property of AVENTICS GmbH. It may not be reproduced or given to third parties without its consent. Only use the AVENTICS products shown in industrial applications. Read the product documentation completely and carefully before using the product. Observe the applicable regulations and laws of the respective country. When integrating the product into applications, note the system manufacturer's specifications for safe use of the product. The data specified only serve to describe the product. No statements concerning a certain condition or suitability for a certain application can be derived from our information. The information given does not release the user from the obligation of own judgement and verification. It must be remembered that the products are subject to a natural process of wear and aging.

The Emerson logo is a trademark and service mark of Emerson Electric Co. Brand logotype are registered trademarks of one of the Emerson family of companies. All other marks are the property of their respective owners. © 2020 Emerson Electric Co. All rights reserved.
2020-12



CONSIDER IT SOLVED™