







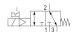

3/2-directional valve, Series CD04

- 3/2
- Qn = 900 l/min
- Pilot valve width : 26 mm
- NC, NO
- Pipe connection
- Compressed air connection output : 1/8-27 PTF
- Electrical connection : Plug, EN 175301-803, form B, 3-pin
- Manual override : with detent
- With spring return
- Pilot : Internal

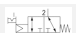

Type	Spool valve, positive overlapping
Activation	Electrically
Pilot	Internal
Sealing principle	Soft sealing
Working pressure min./max.	3 ... 10 bar
Control pressure min./max.	3 ... 10 bar
Ambient temperature min./max.	-15 ... 50 °C
Medium temperature min./max.	-15 ... 50 °C
Medium	Compressed air
Max. particle size	50 µm
Oil content of compressed air	0 ... 1 mg/m³
Nominal flow Qn	900 l/min
Nominal flow 1 ► 2	900 l/min
Nominal flow 2 ► 3	900 l/min
Compressed air connection	according to ANSI B1.20.3
Connector standard	EN 175301-803:2006
Protection class with connection	IP65
Compatibility index	14
Duty cycle	100 %
Weight	See table below

Technical data

Part No.		MO		Compressed air connection
				Input
R412012695			NC, NO	1/8-27 PTF
R412012696			NC, NO	1/8-27 PTF
R412012698			NC, NO	1/8-27 PTF
R412012700			NC, NO	1/8-27 PTF

Part No.	Compressed air connection	Compressed air connection
	Output	Exhaust
R412012695	1/8-27 PTF	1/8-27 PTF
R412012696	1/8-27 PTF	1/8-27 PTF
R412012698	1/8-27 PTF	1/8-27 PTF
R412012700	1/8-27 PTF	1/8-27 PTF

Part No.	Compressed air connection	Operational voltage	Operational voltage
	Pilot Exhaust	DC	AC 50 Hz
R412012695	M5	12 V	-
R412012696	M5	24 V	-
R412012698	M5	-	110 V
R412012700	M5	-	-

Part No.	Operational voltage	Voltage tolerance	Voltage tolerance	Voltage tolerance
	AC 60 Hz	DC	AC 50 Hz	AC 60 Hz
R412012695	-	-10% / +10%	-	-
R412012696	-	-10% / +10%	-	-
R412012698	110 V	-	-20% / +10%	-10% / +20%
R412012700	-	-	-	-

Part No.	Power consumption	Holding power	Holding power	Switch-on power
	DC	AC 50 Hz	AC 60 Hz	AC 50 Hz
R412012695	4.6 W	-	-	-
R412012696	4.8 W	-	-	-
R412012698	-	8.3 VA	7.2 VA	10.8 VA
R412012700	-	-	-	-

Part No.	Switch-on power	Typ. switch-on time	Typ. switch-off time
	AC 60 Hz		
R412012695	-	13 ms	27 ms
R412012696	-	13 ms	27 ms
R412012698	9.5 VA	13 ms	27 ms
R412012700	-	-	-

Part No.	basic valve with electrical connector	Weight
R412012695	-	0.32 kg
R412012696	-	0.32 kg
R412012698	-	0.32 kg
R412012700	Basic valve without coil	0.26 kg

Nominal flow Qn at 6 bar and Δp = 1 bar, MO = Manual override

Technical information

The min. control pressure must be adhered to, since otherwise faulty switching and valve failure may result!
 The pressure dew point must be at least 15 °C under ambient and medium temperature and may not exceed 3 °C .
 The oil content of compressed air must remain constant during the life cycle.
 Use only the approved oils from AVENTICS. Further information can be found in the “Technical information” document (available in the MediaCentre).
 option valve: The input and output compressed air connections can be exchanged.
 The valve can thereby be used in the NC or NO operating mode.

Technical information

Material	
Housing	Die cast zinc Polyamide fiber-glass reinforced
Seals	Acrylonitrile butadiene rubber

Dimensions

Dimensions in inches

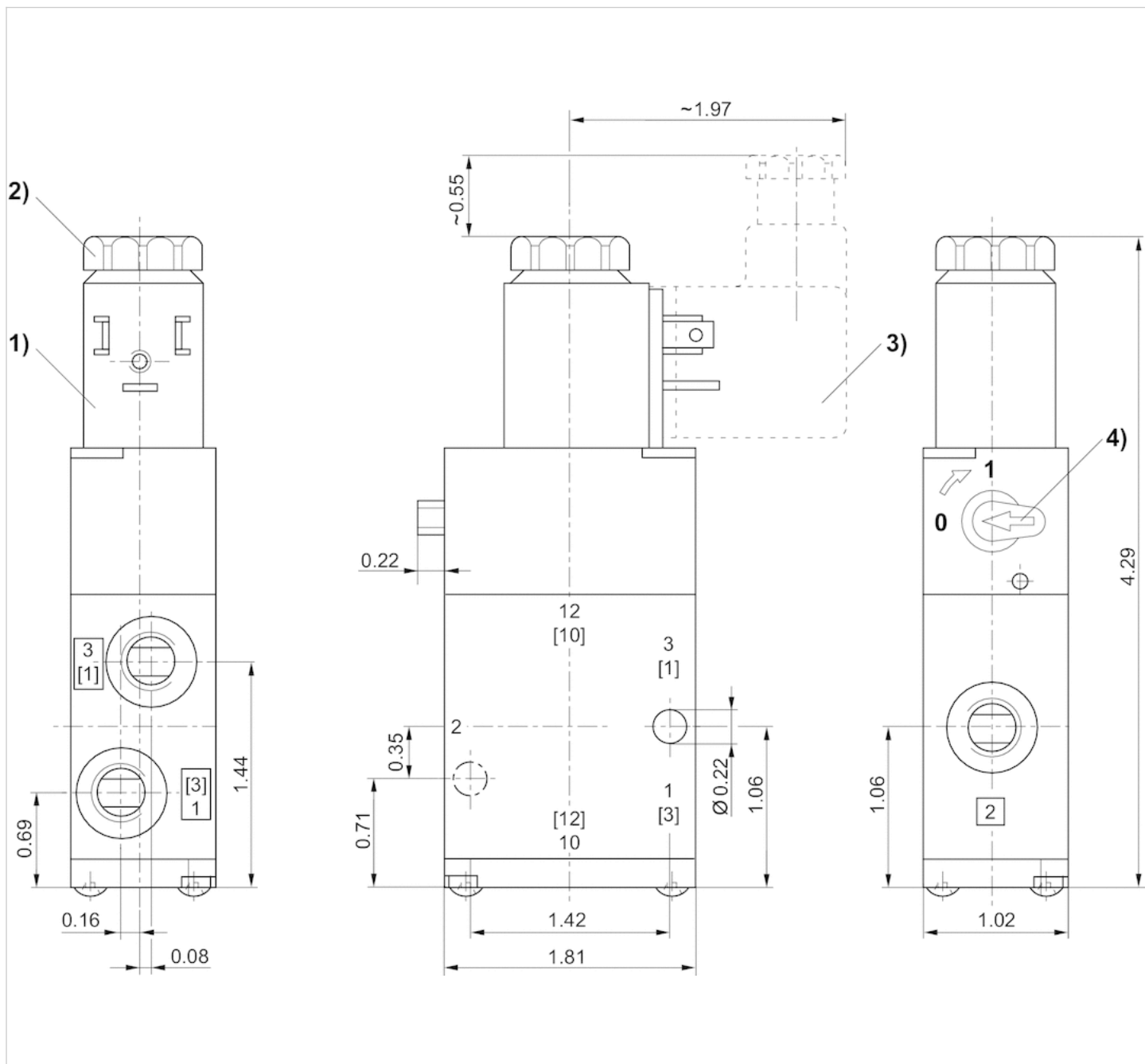

1) Coil can be rotated at 90° intervals 2) After removal of cap M5 internal thread 3) Valve plug connector can be plugged at 180° intervals 4) Manual override

Efficient pneumatic solutions, our program: cylinders and drives, valves and valve systems, air supply management



Visit us: [Emerson.com/Aventics](https://emerson.com/aventics)

Your local contact: [Emerson.com/contactus](https://emerson.com/contactus)



Emerson.com



Facebook.com/EmersonAutomationSolutions



LinkedIn.com/company/Emerson-Automation-Solutions



Twitter.com/EMR_Automation

An example configuration is depicted on the title page. The delivered product may thus vary from that in the illustration. Subject to change. This Document, as well as the data, specifications and other information set forth in it, are the exclusive property of AVENTICS GmbH. It may not be reproduced or given to third parties without its consent. Only use the AVENTICS products shown in industrial applications. Read the product documentation completely and carefully before using the product. Observe the applicable regulations and laws of the respective country. When integrating the product into applications, note the system manufacturer's specifications for safe use of the product. The data specified only serve to describe the product. No statements concerning a certain condition or suitability for a certain application can be derived from our information. The information given does not release the user from the obligation of own judgement and verification. It must be remembered that the products are subject to a natural process of wear and aging.

The Emerson logo is a trademark and service mark of Emerson Electric Co. Brand logotype are registered trademarks of one of the Emerson family of companies. All other marks are the property of their respective owners. © 2020 Emerson Electric Co. All rights reserved.
2020-12



CONSIDER IT SOLVED™