

Lock nut



Weight

See table below

Technical data

Part No.	Suitable piston rod thread	Weight
R412010359	M6x0,5	0,001 kg
R412010360	M8x1	0,002 kg
R412010361	M10x1	0,002 kg
R412010362	M12x1	0,002 kg
R412010363	M14x1,5	0,005 kg
R412010364	M20x1,5	0,011 kg
R412010365	M25x1,5	0,023 kg

Technical information

Material	
	Steel
	salt bath nitrocarburized

Dimensions

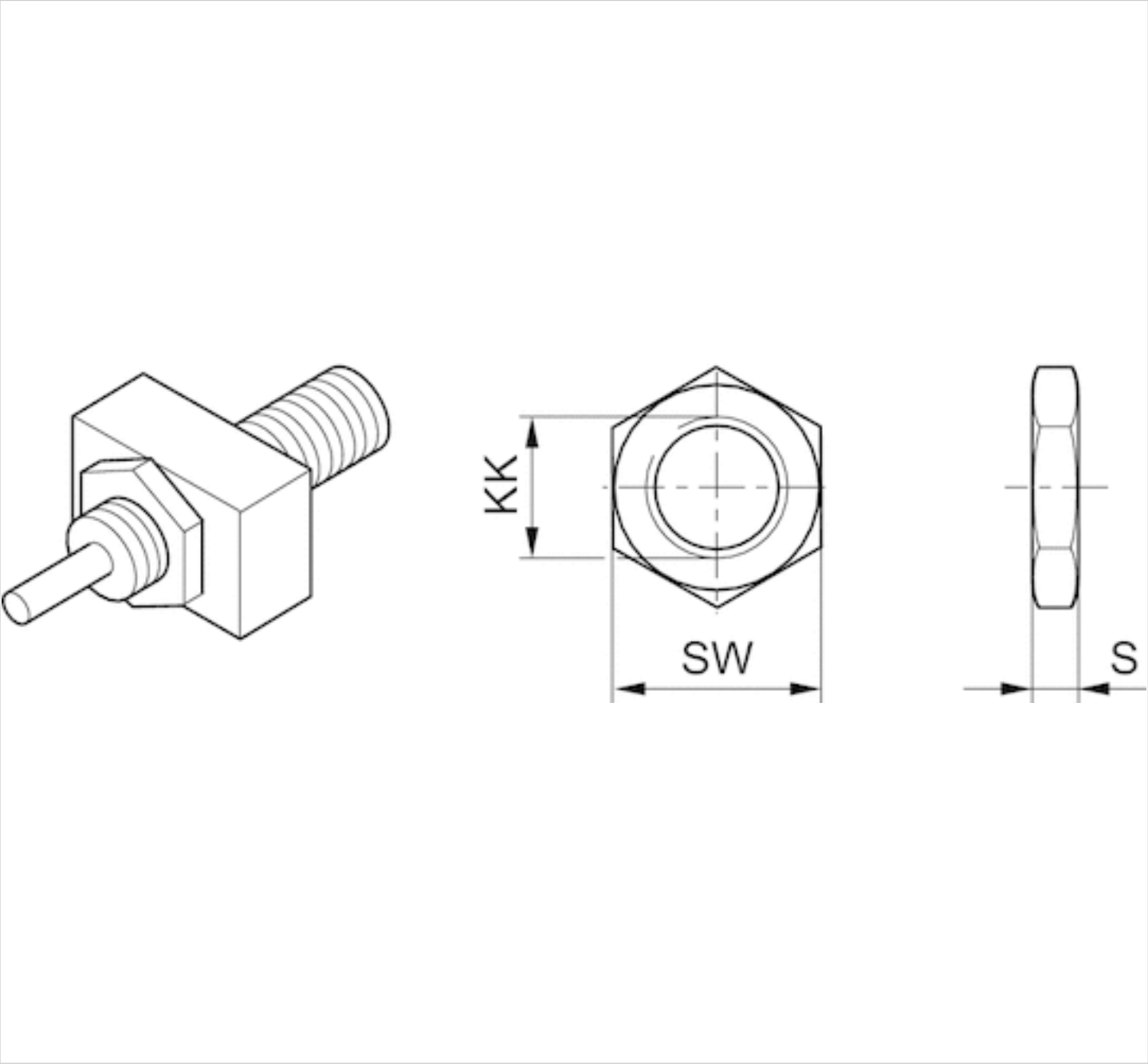

Dimensions

Part No.	KK	For series	S	SW
R412010359	M6x0,5	SA1-MC	3	8
R412010360	M8x1	SA1-MC	3	11
R412010361	M10x1	SA1-MC	3	13
R412010362	M12x1	SA1-MC	4	14
R412010363	M14x1,5	SA1-MC	5	17
R412010364	M20x1,5	SA1-MC	6	24
R412010365	M25x1,5	SA1-MC	8	30

Efficient pneumatic solutions, our program: cylinders and drives, valves and valve systems, air supply management



Visit us: [Emerson.com/Aventics](https://www.emerson.com/Aventics)

Your local contact: [Emerson.com/contactus](https://www.emerson.com/contactus)



Emerson.com



Facebook.com/EmersonAutomationSolutions



LinkedIn.com/company/Emerson-Automation-Solutions



Twitter.com/EMR_Automation

An example configuration is depicted on the title page. The delivered product may thus vary from that in the illustration. Subject to change. This Document, as well as the data, specifications and other information set forth in it, are the exclusive property of AVENTICS GmbH. It may not be reproduced or given to third parties without its consent. Only use the AVENTICS products shown in industrial applications. Read the product documentation completely and carefully before using the product. Observe the applicable regulations and laws of the respective country. When integrating the product into applications, note the system manufacturer's specifications for safe use of the product. The data specified only serve to describe the product. No statements concerning a certain condition or suitability for a certain application can be derived from our information. The information given does not release the user from the obligation of own judgement and verification. It must be remembered that the products are subject to a natural process of wear and aging.

The Emerson logo is a trademark and service mark of Emerson Electric Co. Brand logotype are registered trademarks of one of the Emerson family of companies. All other marks are the property of their respective owners. © 2020 Emerson Electric Co. All rights reserved.
2020-12



CONSIDER IT SOLVED™