

Silencers, series SI1

- G 1/8 G 1/4 G 3/8 G 1/2 G 3/4 G 1

- Metal braiding



Working pressure min./max.

Ambient temperature min./max.

Medium

Sound pressure level

Comment

0 ... 15 bar

-10 ... 150 °C

Compressed air

See table below

Flow characteristic curves can be found under "Diagrams".

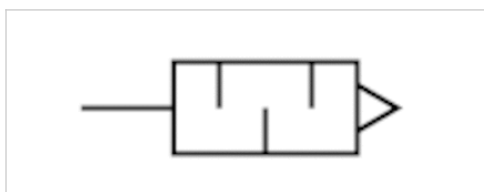

Technical data

Part No.	Compressed air connection	Sound pressure level	Flow	Delivery unit
			Qn	
R412010283	G 1/8	94 dB	1664 l/min	10 piece
R412010245	G 1/4	96 dB	2687 l/min	10 piece
R412010246	G 3/8	98 dB	4709 l/min	5 piece
R412010247	G 1/2	100 dB	6285 l/min	5 piece
R412010248	G 3/4	102 dB	6455 l/min	2 piece
R412010249	G 1	104 dB	10642 l/min	2 piece

Nominal flow Qn at p1 = 6 bar (absolute) freely discharged. Sound pressure level measured at 6 bar against atmosphere at 1 m distance.

Technical information

Material	
Silencer	Metal braiding
Thread	Aluminum

Dimensions

Dimensions

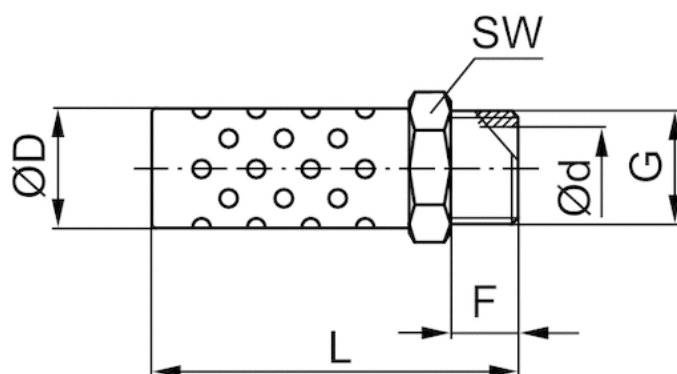

Dimensions

Part No.	Port G	L	F	D	d	SW
R412010283	G 1/8	33.5	6	10.4	6	11
R412010245	G 1/4	42.5	8.5	13.4	8.5	14
R412010246	G 3/8	49.2	9	16.5	12	17
R412010247	G 1/2	65.2	11	21.5	15	22
R412010248	G 3/4	74.5	12	26.5	20	27
R412010249	G 1	91	15.5	32.3	26	34

Sound pressure level measured at 6 bar at 1 m distance

Diagrams

Flow diagram, R412010283

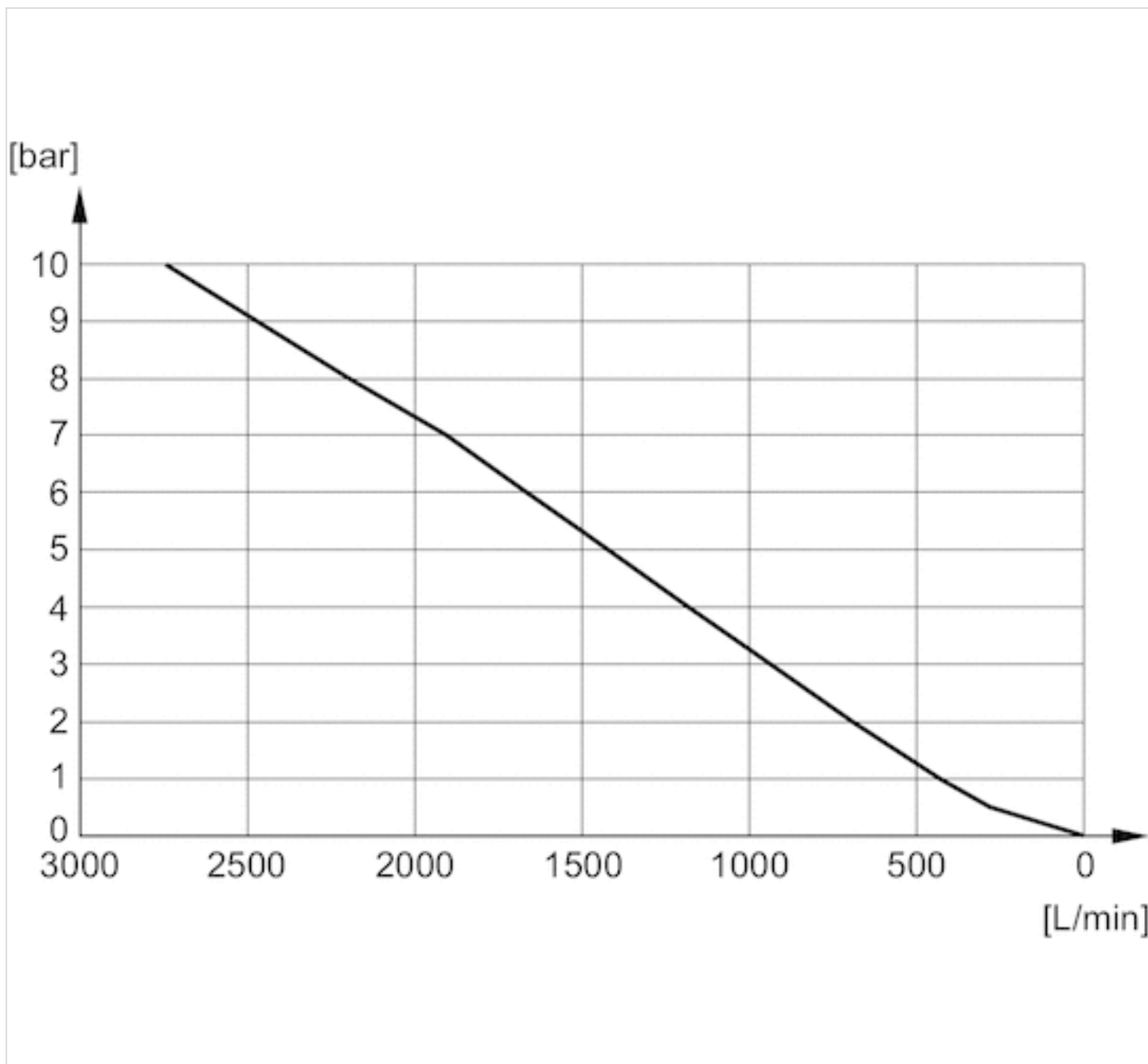

Flow diagram, R412010245

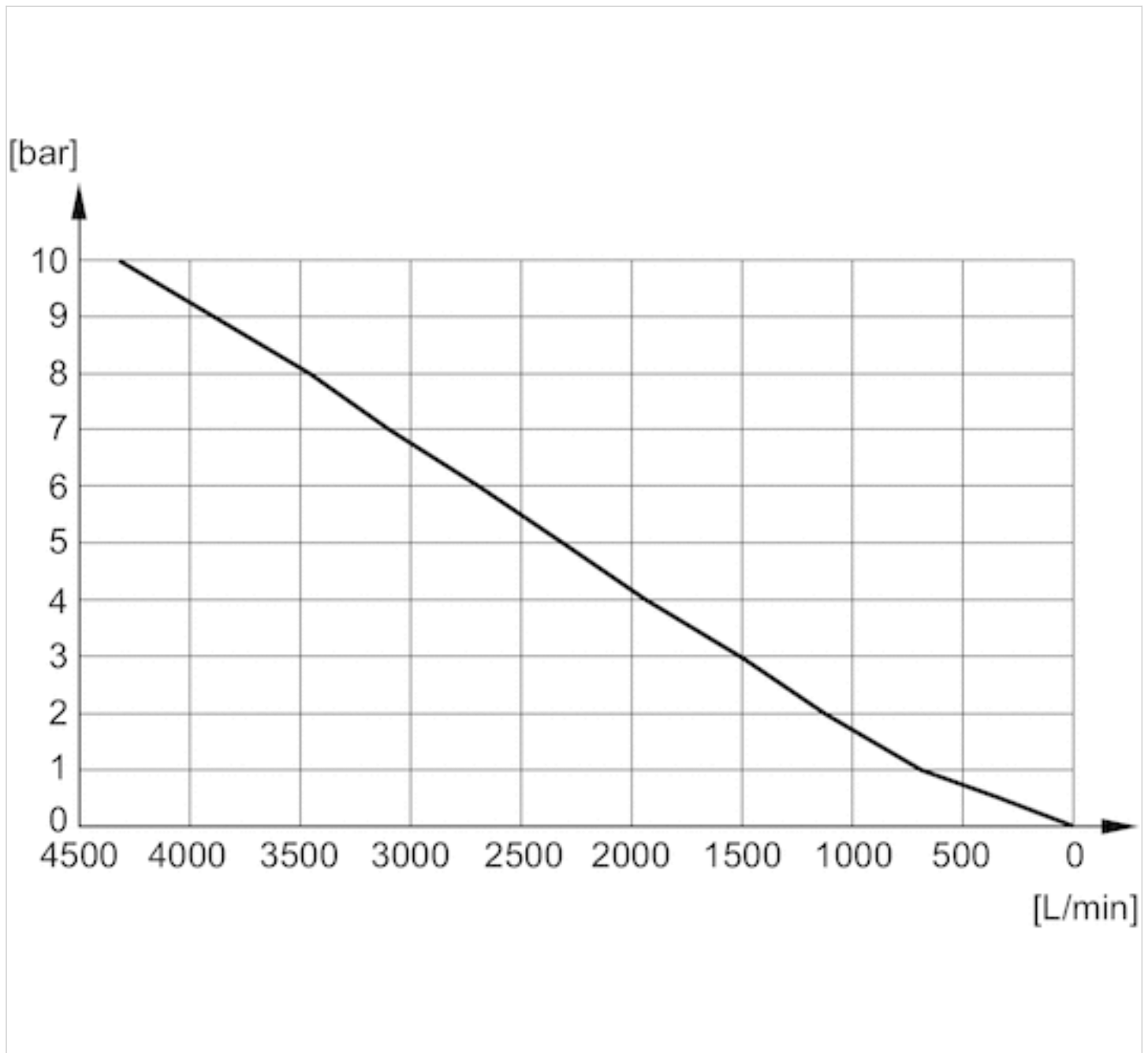

Flow diagram, R412010246

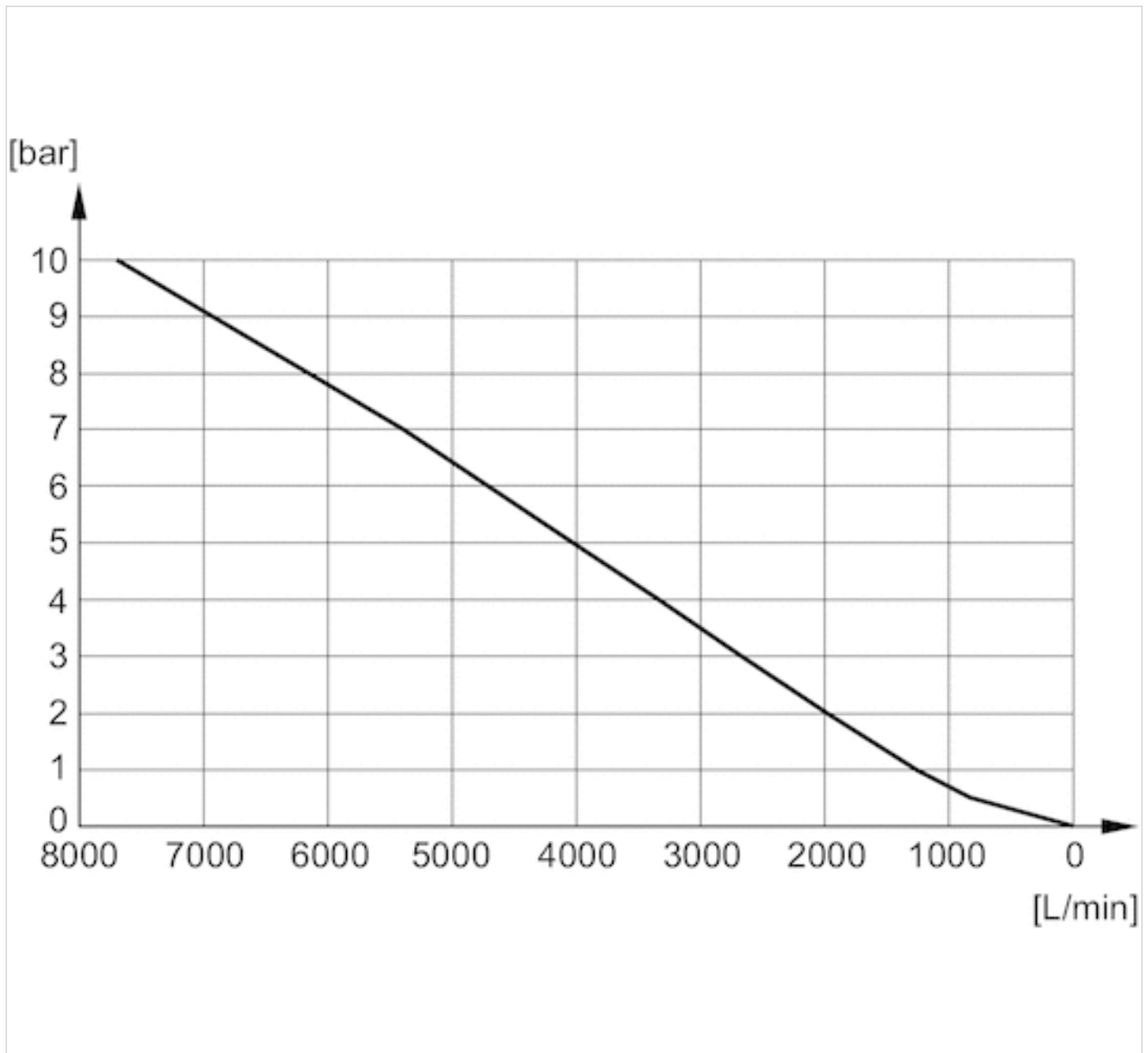

Flow diagram, R412010247

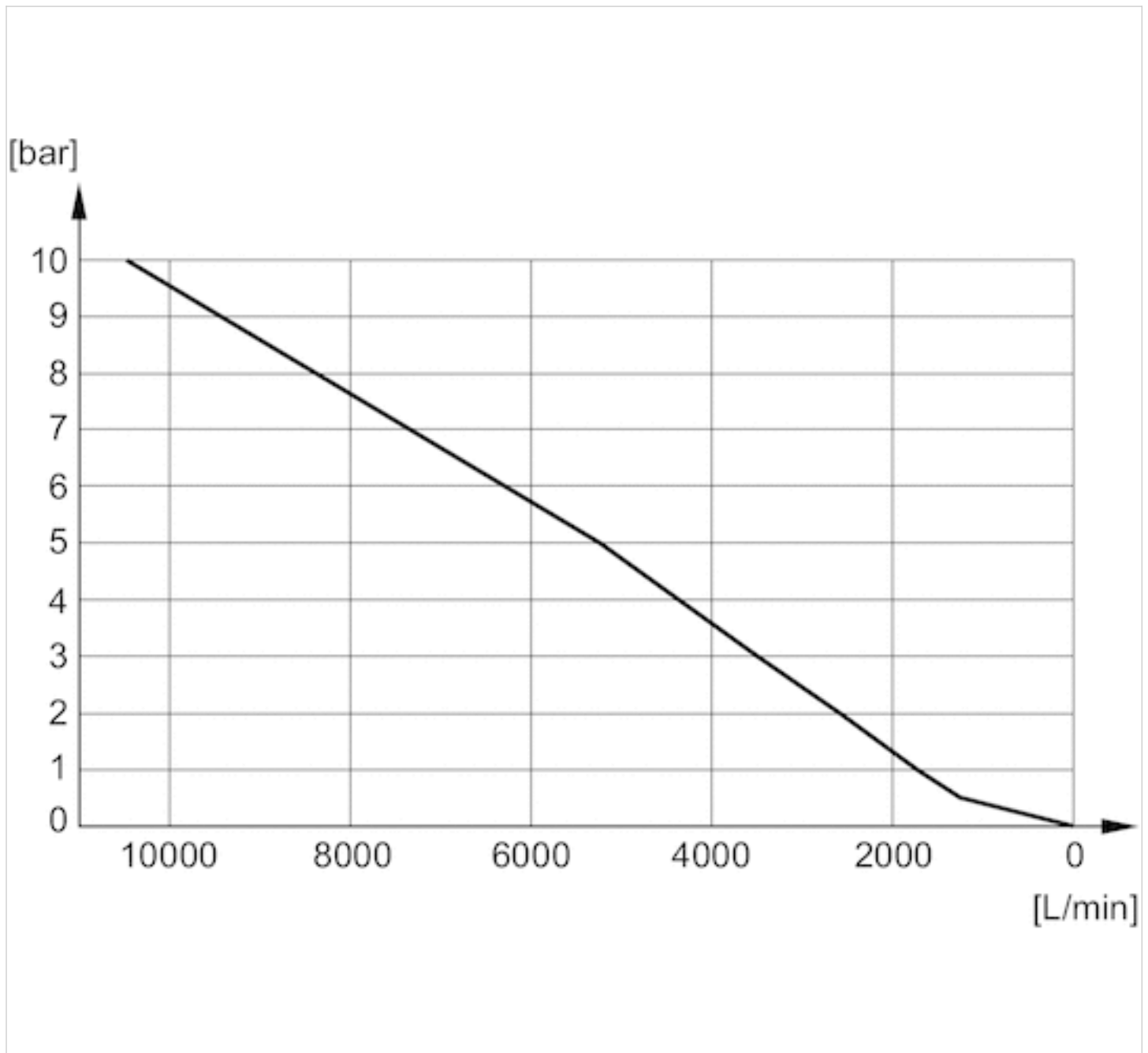

Flow diagram, R412010248

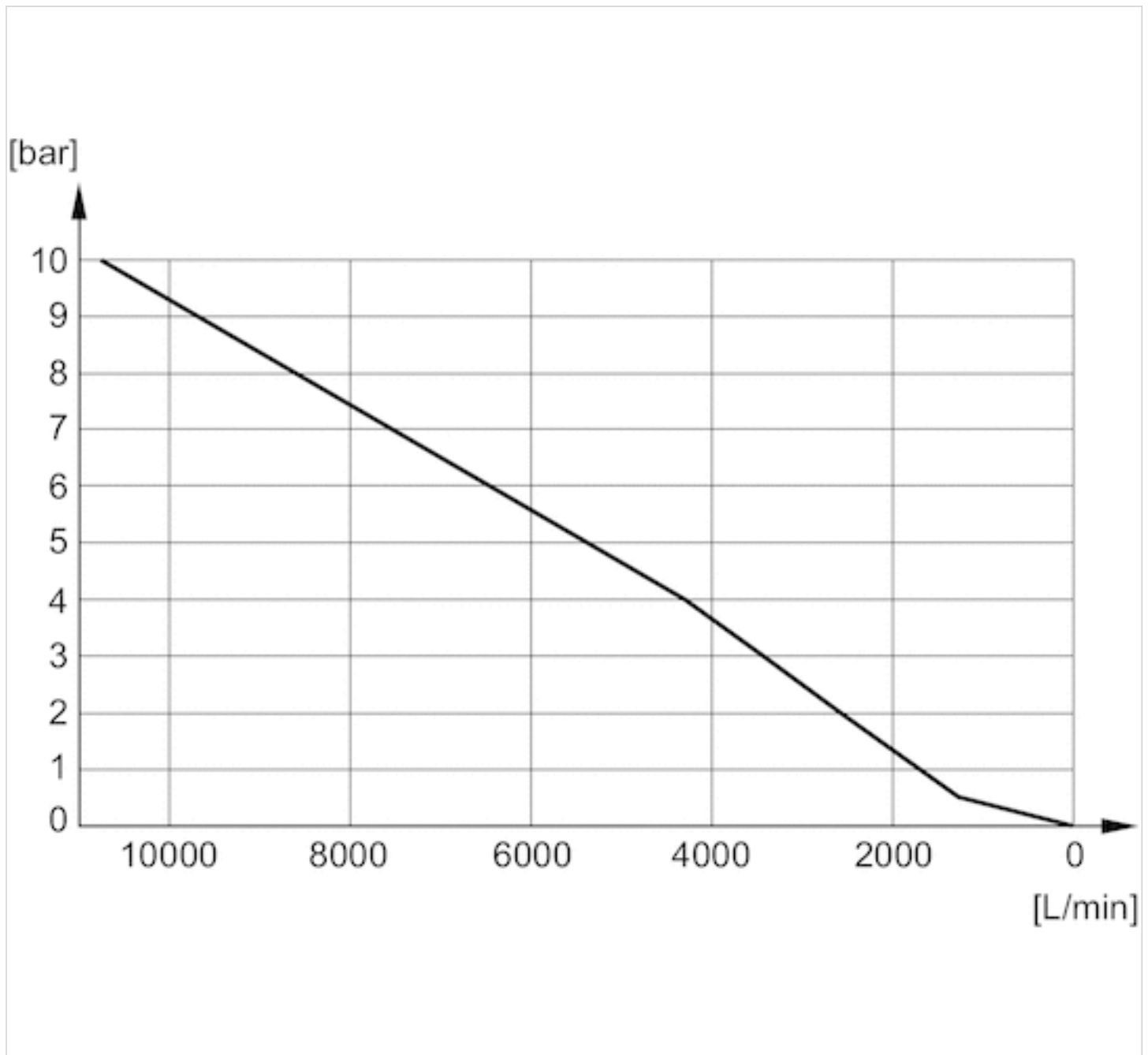

Flow diagram, R412010249

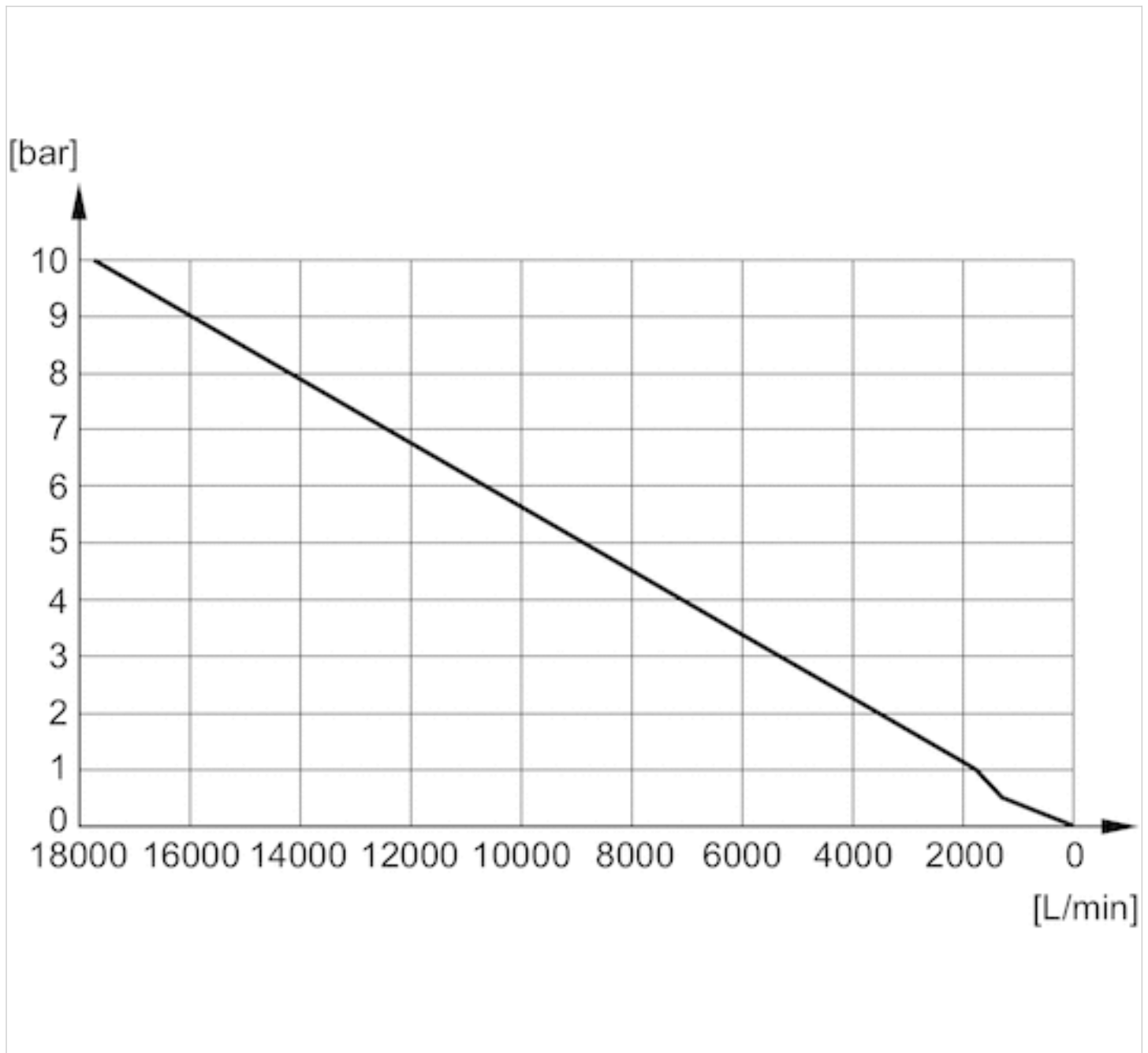

Efficient pneumatic solutions, our program: cylinders and drives, valves and valve systems, air supply management



Visit us: [Emerson.com/Aventics](https://www.emerson.com/Aventics)

Your local contact: [Emerson.com/contactus](https://www.emerson.com/contactus)



[Emerson.com](https://www.emerson.com)



[Facebook.com/EmersonAutomationSolutions](https://www.facebook.com/EmersonAutomationSolutions)



[LinkedIn.com/company/Emerson-Automation-Solutions](https://www.linkedin.com/company/Emerson-Automation-Solutions)



[Twitter.com/EMR_Automation](https://twitter.com/EMR_Automation)

An example configuration is depicted on the title page. The delivered product may thus vary from that in the illustration. Subject to change. This Document, as well as the data, specifications and other information set forth in it, are the exclusive property of AVENTICS GmbH. It may not be reproduced or given to third parties without its consent. Only use the AVENTICS products shown in industrial applications. Read the product documentation completely and carefully before using the product. Observe the applicable regulations and laws of the respective country. When integrating the product into applications, note the system manufacturer's specifications for safe use of the product. The data specified only serve to describe the product. No statements concerning a certain condition or suitability for a certain application can be derived from our information. The information given does not release the user from the obligation of own judgement and verification. It must be remembered that the products are subject to a natural process of wear and aging.

The Emerson logo is a trademark and service mark of Emerson Electric Co. Brand logotype are registered trademarks of one of the Emerson family of companies. All other marks are the property of their respective owners. © 2021 Emerson Electric Co. All rights reserved.
2021-06



CONSIDER IT SOLVED™