

Filter, Series MU1-FLS

- G 1

- filter porosity 40 µm



Type	Standard filter
Parts	Filter
Mounting orientation	vertical
Working pressure min./max.	See table below
Ambient temperature min./max.	-10 ... 60 °C
Medium temperature min./max.	-10 ... 60 °C
Medium	Compressed air Neutral gases
Filter reservoir volume	65 cm ³
Filter element	exchangeable
filter porosity	40 µm
Condensate drain	See table below
Weight	1,05 kg

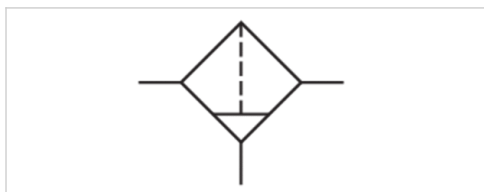

Technical data

Part No.	Port	Flow Qn	Working pressure min./max.	Condensate drain
R412006562	G 1	4000 l/min	2 ... 16 bar	semi-automatic, open without pressure
R412006585	G 1	4000 l/min	0 ... 25 bar	Manual

Part No.	Version	ATEX	
R412006562	reservoir, polycarbonate, with metal protective guard	suitable for ATEX	1)
R412006585	Metal reservoir without window	-	-

Nominal flow Qn with secondary pressure p₂ = 6 bar at Δp = 1 bar

1) Suitable for use in Ex zones 1, 2, 21, 22.

Technical information

The pressure dew point must be at least 15 °C under ambient and medium temperature and may not exceed 3 °C .
 Mounting: mounting bracket R412004874 or installation in piping

Technical information

Material	
Housing	Die-cast aluminum
Seals	Acrylonitrile butadiene rubber
Reservoir	Polycarbonate Die cast zinc

Material	
Protective guard	Steel
Filter insert	Polyethylene

Dimensions

Dimensions

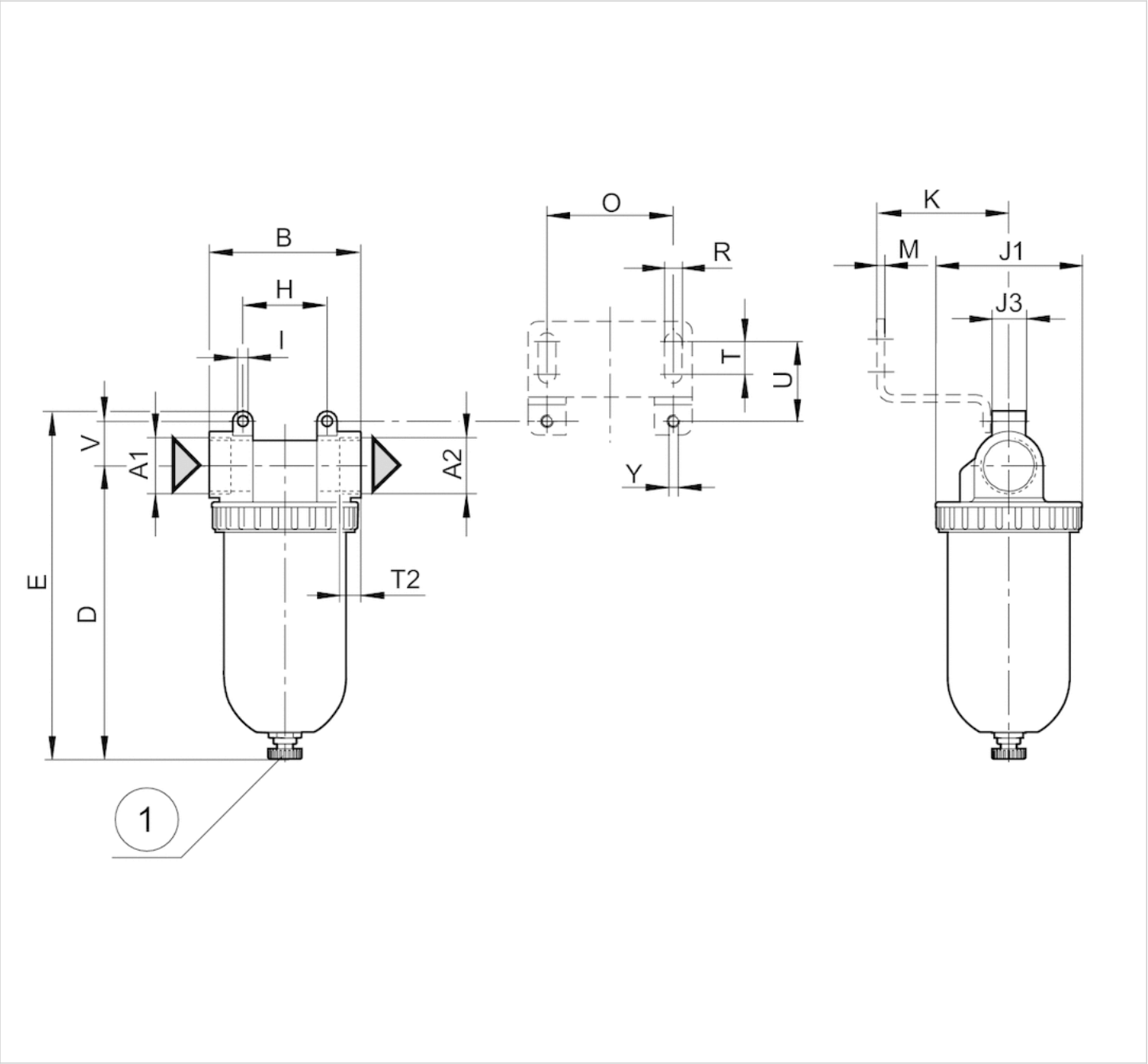

1) manual or semi-automatic condensate drain

Dimensions

A1	A2	B	D ±5	E ±7	H	I	J1	J3	K	M	O	R	T	T2	U	V	Y
G 1	G 1	90	174	206	50	6.2	87	20	55	3	50	7	13	16	31.5	26.5	M6

Diagrams

Flow rate characteristic

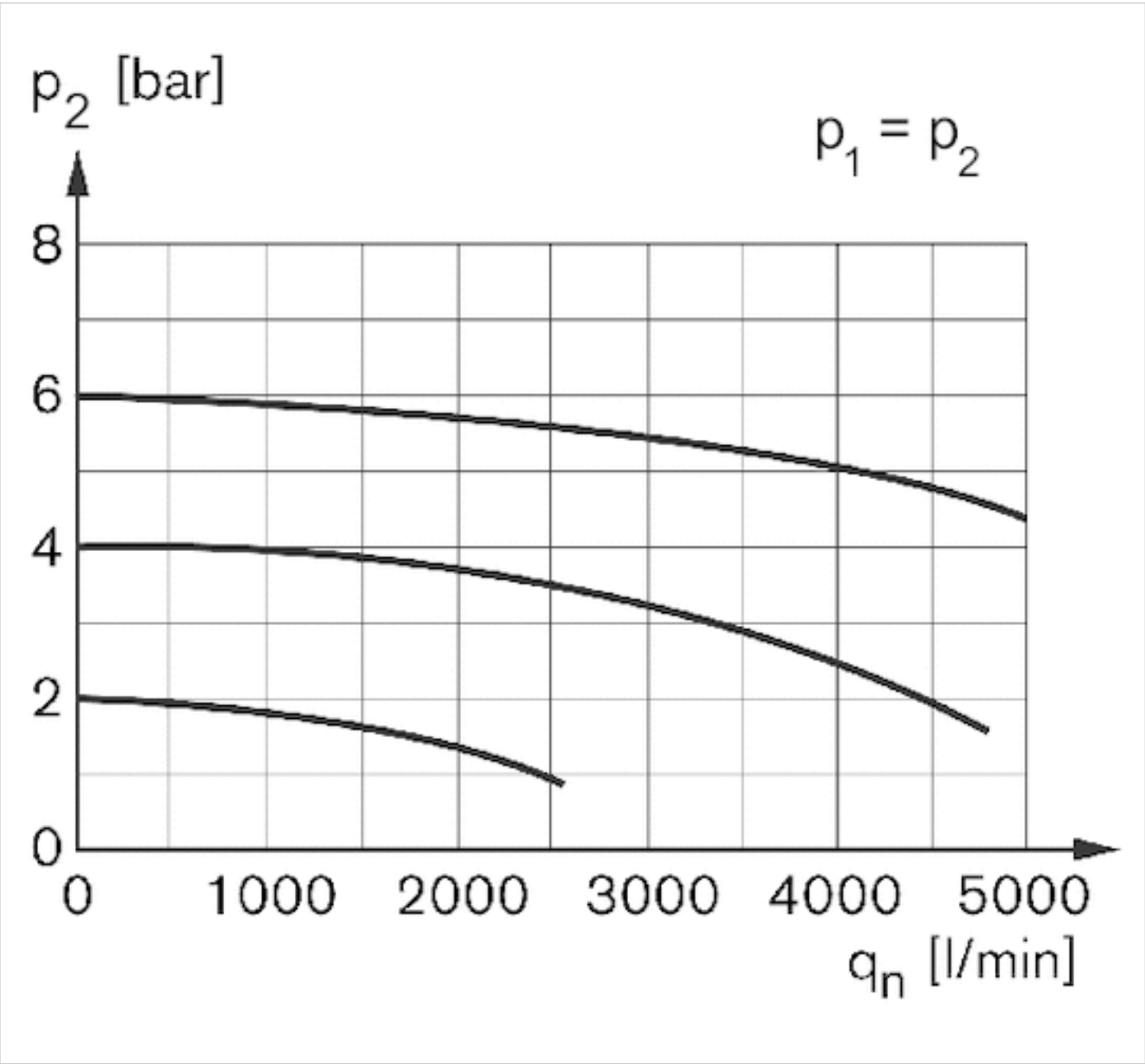

p_2 = secondary pressure
 q_n = nominal flow

Efficient pneumatic solutions, our program: cylinders and drives, valves and valve systems, air supply management



Visit us: [Emerson.com/Aventics](https://www.emerson.com/Aventics)

Your local contact: [Emerson.com/contactus](https://www.emerson.com/contactus)



Emerson.com



Facebook.com/EmersonAutomationSolutions



LinkedIn.com/company/Emerson-Automation-Solutions



Twitter.com/EMR_Automation

An example configuration is depicted on the title page. The delivered product may thus vary from that in the illustration. Subject to change. This Document, as well as the data, specifications and other information set forth in it, are the exclusive property of AVENTICS GmbH. It may not be reproduced or given to third parties without its consent. Only use the AVENTICS products shown in industrial applications. Read the product documentation completely and carefully before using the product. Observe the applicable regulations and laws of the respective country. When integrating the product into applications, note the system manufacturer's specifications for safe use of the product. The data specified only serve to describe the product. No statements concerning a certain condition or suitability for a certain application can be derived from our information. The information given does not release the user from the obligation of own judgement and verification. It must be remembered that the products are subject to a natural process of wear and aging.

The Emerson logo is a trademark and service mark of Emerson Electric Co. Brand logotype are registered trademarks of one of the Emerson family of companies. All other marks are the property of their respective owners. © 2020 Emerson Electric Co. All rights reserved.
2020-12



CONSIDER IT SOLVED™