

5/2-directional valve, Series 581, size 3

- ISO 5599-1
- ISO 3
- 5/2
- With differential piston
- With air spring return
- $Q_n = 4800 \text{ l/min}$
- Compressed air connection output Base plate ISO 5599-1
- Electrical connection Plug, EN 175301-803, form A
- Manual override with detent, without detent



Type	Spool valve
Sealing principle	Soft sealing
Blocking principle	Single base plate principle
Connection type	Plate connection
Standards	ISO 5599-1, ISO 3
Working pressure min./max.	See table below
Control pressure min./max.	1,5 ... 10 bar
Ambient temperature min./max.	-15 ... 50 °C
Medium temperature min./max.	-15 ... 50 °C
Medium	Compressed air
Max. particle size	50 µm
Oil content of compressed air	0 ... 5 mg/m ³
Nominal flow Q_n	4800 l/min
Flow conductance C	18,9 l/(s*bar)
Protection class with connection	IP65
Compatibility index	14
Duty cycle	100 %
Typ. switch-on time	24 ms
Typ. switch-off time	66 ms
Mounting screw	with hexagon socket
Mounting screw tightening torque	10 Nm
Weight	0,99 kg

[illegible]

Part No.	Switch-on power AC 50 Hz	Pilot	Working pressure min./max.	Compatibility index
5813670650	-	Internal	1,5 ... 10 bar	14
5813670450	7 VA	Internal	1,5 ... 10 bar	14
5813671650	-	Internal	1,5 ... 10 bar	14
5813671450	7 VA	Internal	1,5 ... 10 bar	14
5813672650	-	External	-0,95 ... 10 bar	14
5813672450	7 VA	External	-0,95 ... 10 bar	14
5813673650	-	External	-0,95 ... 10 bar	14
5813673450	7 VA	External	-0,95 ... 10 bar	14

Part No.	Electrical connection Pilot valve	Throttle
5813670650	Plug EN 175301-803, form A	-
5813670450	Plug EN 175301-803, form A	-
5813671650	Plug EN 175301-803, form A	with throttle
5813671450	Plug EN 175301-803, form A	with throttle
5813672650	Plug EN 175301-803, form A	-
5813672450	Plug EN 175301-803, form A	-
5813673650	Plug EN 175301-803, form A	with throttle
5813673450	Plug EN 175301-803, form A	with throttle

PDF creation date: 01.12.2020

Technical information

The min. control pressure must be adhered to, since otherwise faulty switching and valve failure may result!
The pressure dew point must be at least 15 °C under ambient and medium temperature and may not exceed 3 °C .
The oil content of compressed air must remain constant during the life cycle.
Use only the approved oils from AVENTICS. Further information can be found in the “Technical information” document (available in the MediaCentre).
Differential piston, signal 14 has priority
The minimum pilot pressure at port 14 is dependent on the pressure in port 1.

Technical information

Housing	Aluminum
Seals	Acrylonitrile butadiene rubber

Dimensions

Dimensions

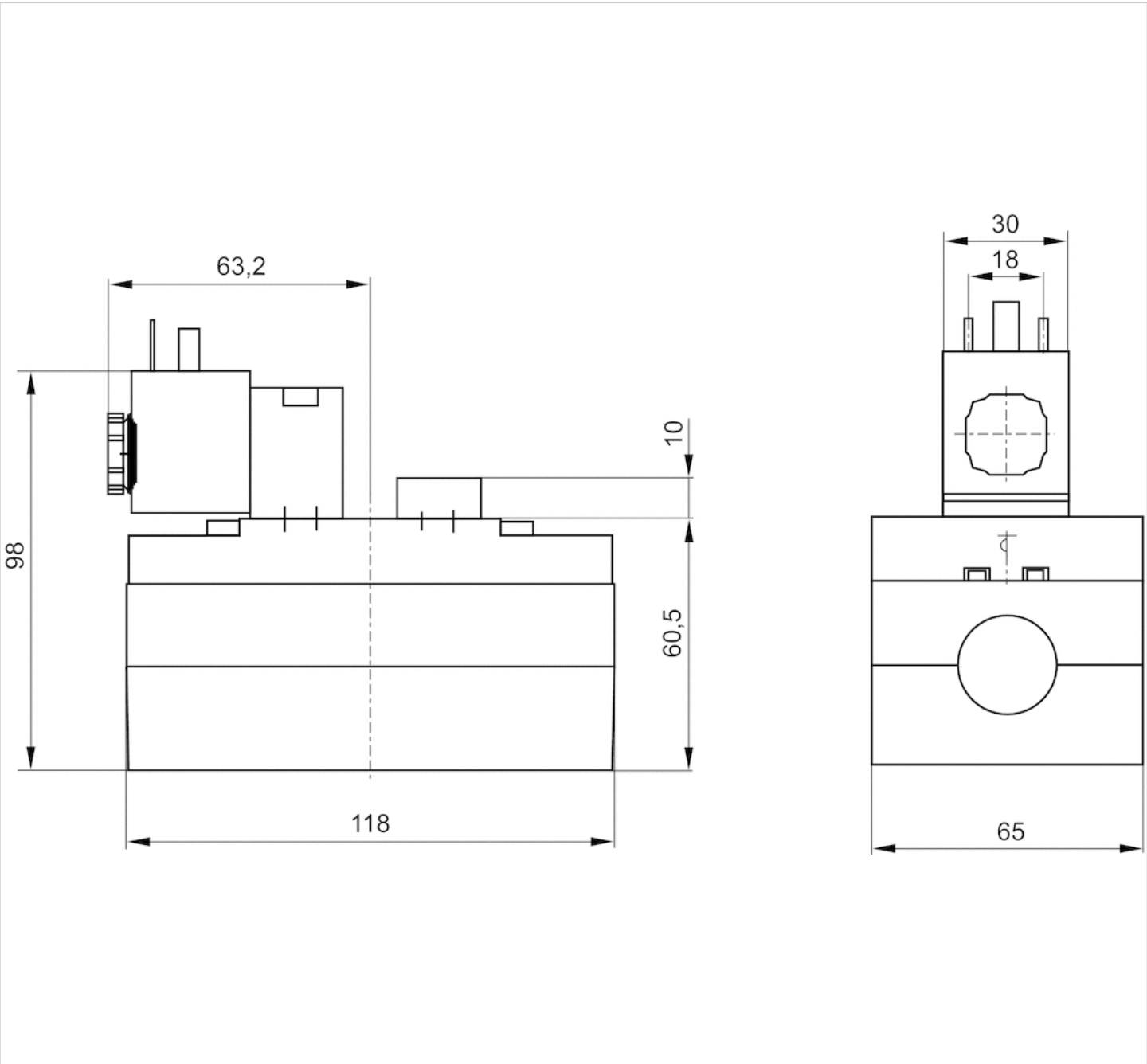

Efficient pneumatic solutions, our program: cylinders and drives, valves and valve systems, air supply management



Visit us: [Emerson.com/Aventics](https://emerson.com/aventics)

Your local contact: [Emerson.com/contactus](https://emerson.com/contactus)



Emerson.com



Facebook.com/EmersonAutomationSolutions



LinkedIn.com/company/Emerson-Automation-Solutions



Twitter.com/EMR_Automation

An example configuration is depicted on the title page. The delivered product may thus vary from that in the illustration. Subject to change. This Document, as well as the data, specifications and other information set forth in it, are the exclusive property of AVENTICS GmbH. It may not be reproduced or given to third parties without its consent. Only use the AVENTICS products shown in industrial applications. Read the product documentation completely and carefully before using the product. Observe the applicable regulations and laws of the respective country. When integrating the product into applications, note the system manufacturer's specifications for safe use of the product. The data specified only serve to describe the product. No statements concerning a certain condition or suitability for a certain application can be derived from our information. The information given does not release the user from the obligation of own judgement and verification. It must be remembered that the products are subject to a natural process of wear and aging.

The Emerson logo is a trademark and service mark of Emerson Electric Co. Brand logotype are registered trademarks of one of the Emerson family of companies. All other marks are the property of their respective owners. © 2020 Emerson Electric Co. All rights reserved.
2020-12



CONSIDER IT SOLVED™