

Spring-loaded plunger, Series PSL



Type

not non-rotating

Ambient temperature min./max.

0 ... 80 °C

Weight

See table below

Technical data

Part No.	Type	Spring rate	Spring pre-tensioning	Max. vertical load (static)
0821305171	not non-rotating	0,596 N/mm	1,49 N	550 N
0821305172	not non-rotating	0,323 N/mm	2,75 N	1500 N
0821305173	not non-rotating	0,221 N/mm	3,53 N	3700 N
0821305174	not non-rotating	0,143 N/mm	3,57 N	3700 N
0821305175	not non-rotating	0,097 N/mm	2,92 N	3700 N
0821305176	not non-rotating	0,711 N/mm	6,47 N	2400 N
0821305177	not non-rotating	0,452 N/mm	1,4 N	2400 N
0821305178	not non-rotating	0,262 N/mm	5,38 N	2400 N
0821305179	not non-rotating	3,829 N/mm	25,64 N	4900 N
0821305180	not non-rotating	1,072 N/mm	37,2 N	4900 N

Part No.	Max. horizontal load (static)	Bending moment	Weight	Fig.
0821305171	47 N	0,7 Nm	0,009 kg	Fig. 1
0821305172	97 N	2,2 Nm	0,019 kg	Fig. 1
0821305173	385 N	13,9 Nm	0,08 kg	Fig. 2
0821305174	283 N	13,9 Nm	0,09 kg	Fig. 2
0821305175	173 N	13,9 Nm	0,11 kg	Fig. 2
0821305176	747 N	36,6 Nm	0,145 kg	Fig. 2
0821305177	466 N	36,6 Nm	0,175 kg	Fig. 2
0821305178	340 N	36,6 Nm	0,19 kg	Fig. 2
0821305179	1870 N	99,1 Nm	0,4 kg	Fig. 2
0821305180	800 N	99,1 Nm	0,53 kg	Fig. 2

Technical information

Material	
Housing	Steel, galvanized
Guide bushing	Brass
Spring	Steel

Material	
Nut	Steel, galvanized

Dimensions

Fig. 1

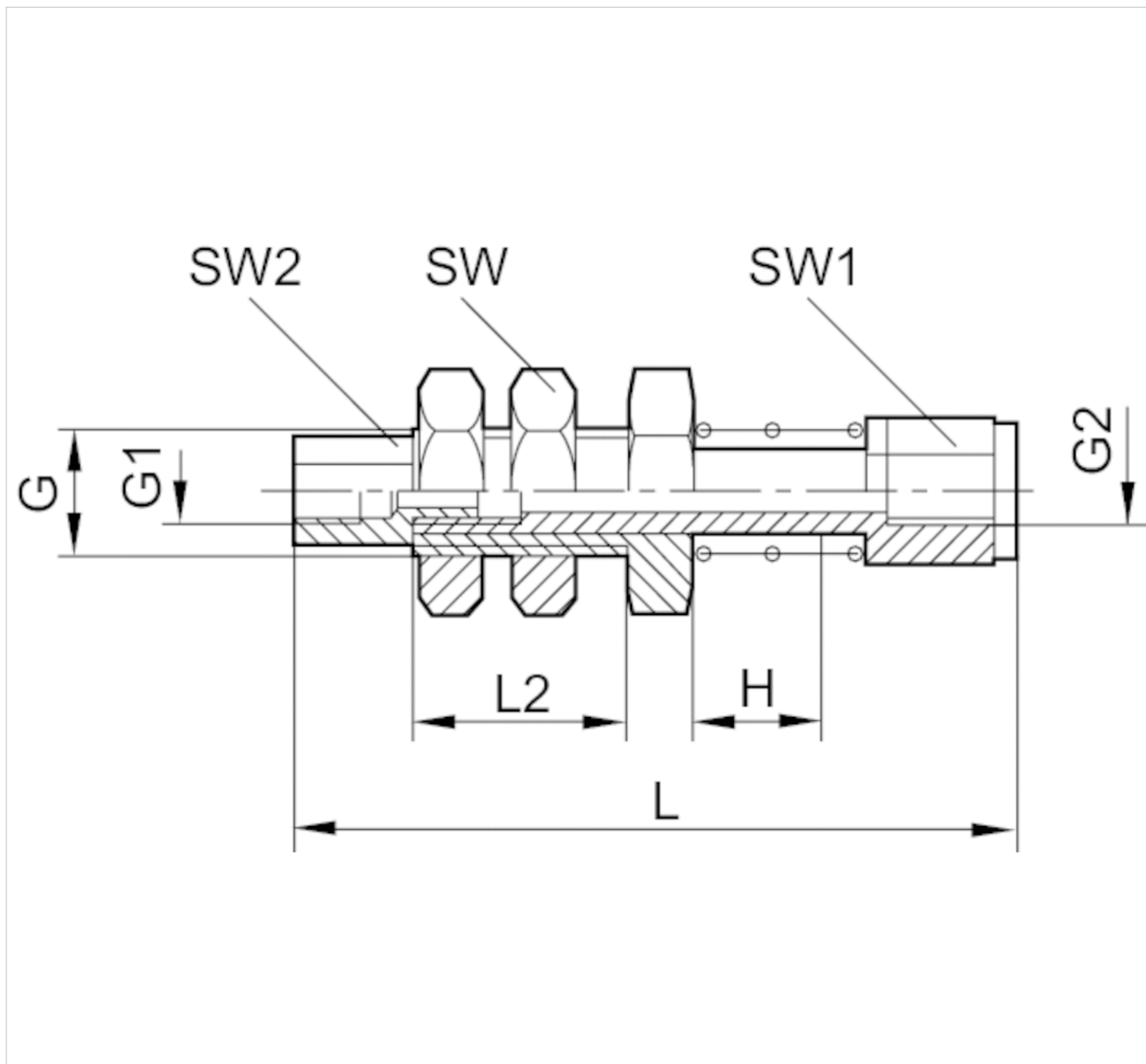

H = stroke

Dimensions

Part No.	G	G1	G2	H	L	L2	SW	SW1	SW2
0821305171	M6x0,75	M3	M3	5	33.5	10	10	7	4.5
0821305172	G 1/8	M5	M5	10	47.2	15	14	7	7

Dimensions

Fig. 2

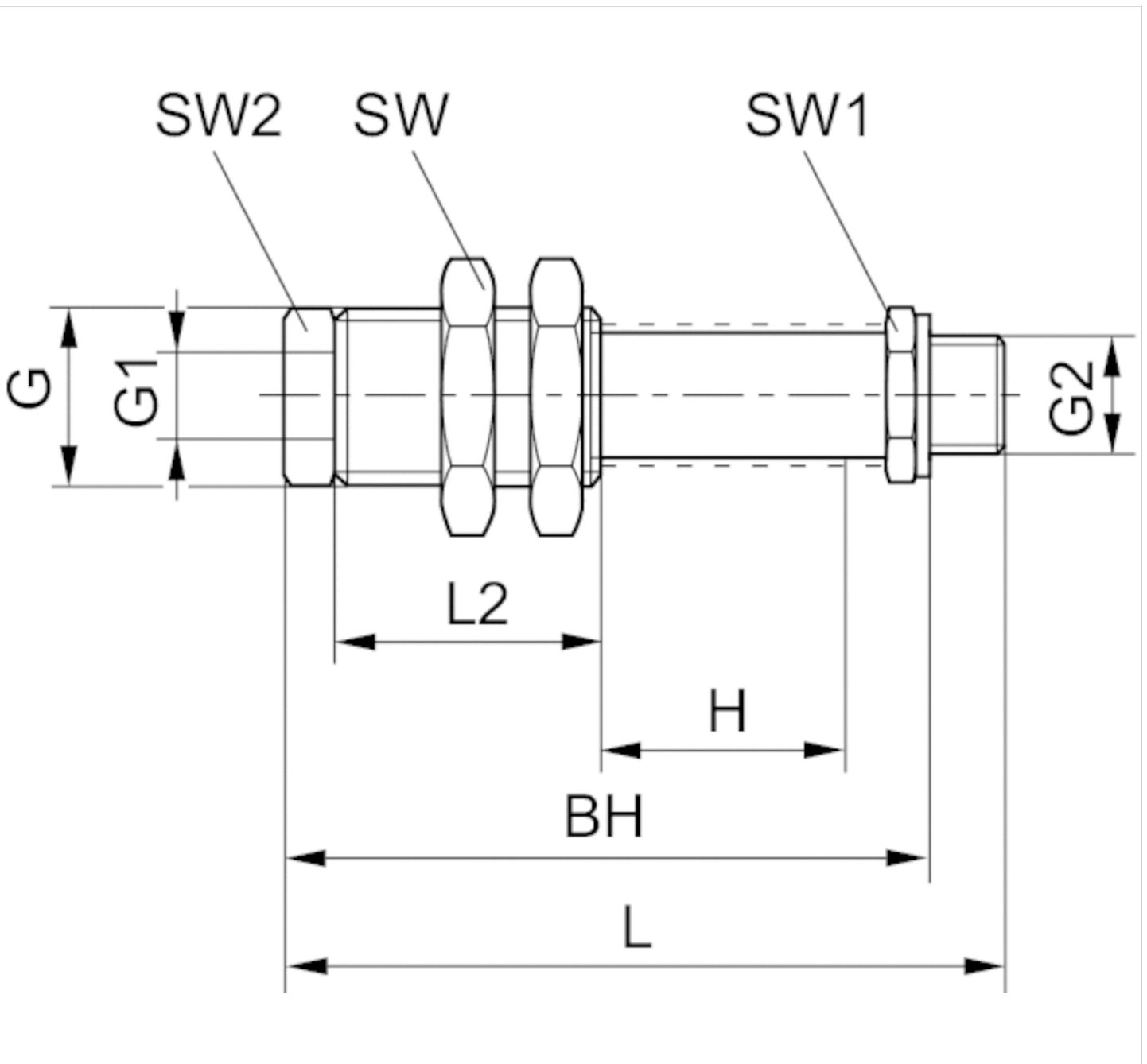

H = stroke

Dimensions

Part No.	G	G1	G2	H	L	L2	SW	SW1	SW2	BH
0821305173	M16x1	G 1/8	G 1/8	15	80	30	22	14	12	73.5
0821305174	M16x1	G 1/8	G 1/8	25	93	30	22	14	12	86.5
0821305175	M16x1	G 1/8	G 1/8	50	124	30	22	14	12	117.5
0821305176	M20x1,5	G 1/8	G 1/4	25	94.5	40	24	17	17	86
0821305177	M20x1,5	G 1/8	G 1/4	50	124	40	24	17	17	115.5
0821305178	M20x1,5	G 1/8	G 1/4	75	153.5	40	24	17	17	145

Part No.	G	G1	G2	H	L	L2	SW	SW1	SW2	BH
0821305179	M30x1,5	G 3/8	G 1/2	25	116	55	36	24	24	105.3
0821305180	M30x1,5	G 3/8	G 1/2	75	187	55	36	24	24	176.5

Efficient pneumatic solutions, our program: cylinders and drives, valves and valve systems, air supply management



Visit us: [Emerson.com/Aventics](https://www.emerson.com/Aventics)

Your local contact: [Emerson.com/contactus](https://www.emerson.com/contactus)



Emerson.com



Facebook.com/EmersonAutomationSolutions



LinkedIn.com/company/Emerson-Automation-Solutions



Twitter.com/EMR_Automation

An example configuration is depicted on the title page. The delivered product may thus vary from that in the illustration. Subject to change. This Document, as well as the data, specifications and other information set forth in it, are the exclusive property of AVENTICS GmbH. It may not be reproduced or given to third parties without its consent. Only use the AVENTICS products shown in industrial applications. Read the product documentation completely and carefully before using the product. Observe the applicable regulations and laws of the respective country. When integrating the product into applications, note the system manufacturer's specifications for safe use of the product. The data specified only serve to describe the product. No statements concerning a certain condition or suitability for a certain application can be derived from our information. The information given does not release the user from the obligation of own judgement and verification. It must be remembered that the products are subject to a natural process of wear and aging.

The Emerson logo is a trademark and service mark of Emerson Electric Co. Brand logotype are registered trademarks of one of the Emerson family of companies. All other marks are the property of their respective owners. © 2020 Emerson Electric Co. All rights reserved.
2020-12



CONSIDER IT SOLVED™