

3/2-directional valve, electrically operated, Series NL6-SOV

- Compressed air connection G 3/4 G 1

- Pipe connection



Type

Parts

Nominal flow 1 ► 2

Nominal flow 2 ► 3

Working pressure min./max.

Medium

Medium temperature min./max.

Ambient temperature min./max.

Pilot

Sealing principle

Protection class acc. to DIN EN 61140 with plug

Duty cycle

Weight

Poppet valve, Can be assembled into blocks

3/2-directional valve, electrically operated

12500 l/min

3900 l/min

2,5 ... 10 bar

Compressed air Neutral gases

-10 ... 60 °C

-10 ... 60 °C

Internal





Soft sealing

IP65

100 %

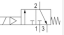
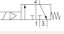
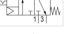
See table below

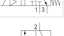
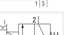
Technical data

Part No.		Compressed air connection input	Compressed air connection output	Exhaust
0821300973		G 3/4	G 3/4	G 1/2
0821300972		G 3/4	G 3/4	G 1/2
0821300971		G 3/4	G 3/4	G 1/2
0821300990		G 3/4	G 3/4	G 1/2
0821300966		G 1	G 1	G 1/2
0821300965		G 1	G 1	G 1/2
0821300964		G 1	G 1	G 1/2
0821300991		G 1	G 1	G 1/2

Part No.	Operational voltage	Operational voltage	Operational voltage
	DC	AC 50 Hz	AC 60 Hz
0821300973	-	-	-
0821300972	24 V	-	-
0821300971	-	230 V	230 V
0821300990	-	-	-
0821300966	-	-	-
0821300965	24 V	-	-
0821300964	-	230 V	230 V
0821300991	-	-	-

Part No.	Power consumption	Holding power	Switch-on power	Manual override
	DC	AC 50 Hz	AC 50 Hz	
0821300973	-	-	-	without
0821300972	4,8 W	-	-	-

Part No.	Power consumption	Holding power	Switch-on power	Manual override
	DC	AC 50 Hz	AC 50 Hz	
0821300971	-	8,5 VA	11,8 VA	-
0821300990	-	-	-	with detent
0821300966	-	-	-	without
0821300965	4,8 W	-	-	-
0821300964	-	8,5 VA	11,8 VA	-
0821300991	-	-	-	with detent

Part No.	Electrical connection	basic valve with electrical connector
	Pilot valve	
0821300973	-	pilot valve without coil
0821300972	Plug, ISO 6952, form B	-
0821300971	Plug, ISO 6952, form B	-
0821300990	-	pilot valve without coil
0821300966	-	pilot valve without coil
0821300965	Plug, ISO 6952, form B	-
0821300964	Plug, ISO 6952, form B	-
0821300991	-	pilot valve without coil

Part No.	Reverse polarity protection	Weight
0821300973	-	1,42 kg
0821300972	Protected against polarity reversal	1,49 kg
0821300971	Protected against polarity reversal	1,49 kg
0821300990	-	1,42 kg
0821300966	-	1,42 kg
0821300965	Protected against polarity reversal	1,49 kg
0821300964	Protected against polarity reversal	1,49 kg
0821300991	-	1,42 kg

Nominal flow Q_n with secondary pressure p₂ = 6 bar at Δp = 1 bar

Technical information

The pressure dew point must be at least 15 °C under ambient and medium temperature and may not exceed 3 °C .

A change in the flow direction (from air supply on the left to air supply on the right) occurs by rotating installation by 180° about the vertical axis. Please see the operating instructions for further details.

The connections on the front and back are not connected to the main air flow. No pressure gauge may be connected here.

Recommended pre-filtering 8 μm

Technical information

Material	
Housing	Die-cast aluminum
Front plate	Acrylonitrile butadiene styrene
Seals	Acrylonitrile butadiene styrene

Dimensions

Dimensions

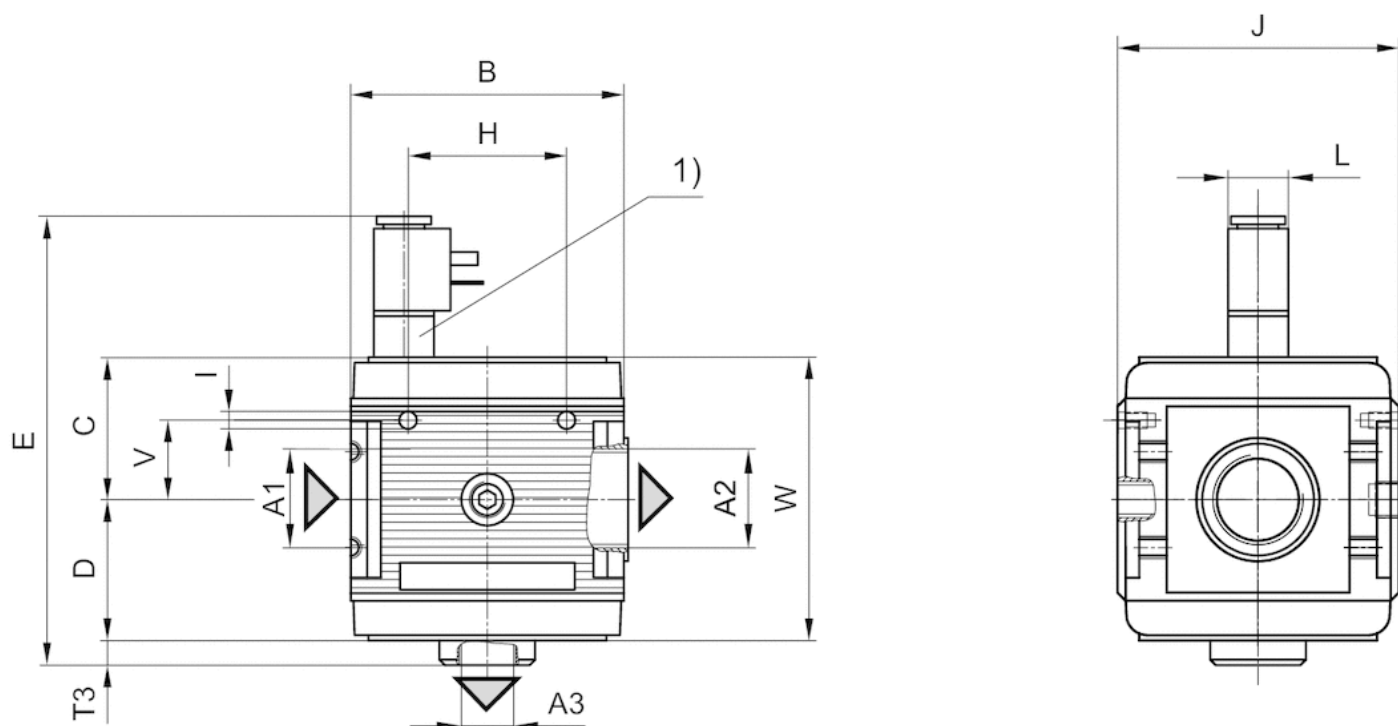

A1 = input

A2 = output

A3 = ventilation port

1) electrically operated

Dimensions in mm

A1	A2	A3	B	C	D	E	H	I	J	L	T3	T5	V	W
G 3/4	G 3/4	G 1/2	100	52	51.5	164.5	58	M6	103	22	9.5	7	29	103.5
G 1	G 1	G 1/2	100	52	51.5	164.5	58	M6	103	22	9.5	7	29	103.5

Diagrams

Flow rate characteristic

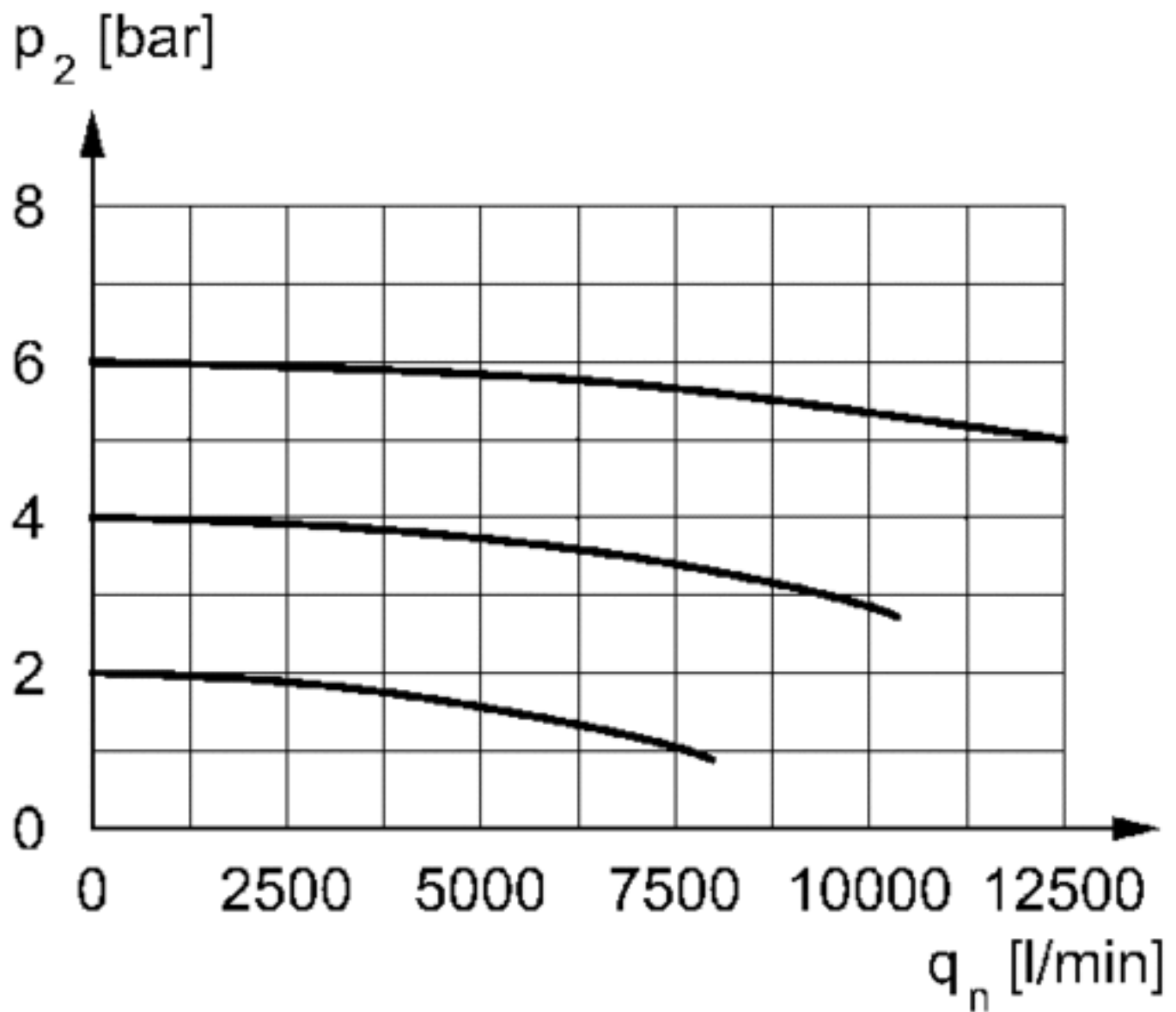

p_2 = secondary pressure
 q_n = nominal flow

Efficient pneumatic solutions, our program: cylinders and drives, valves and valve systems, air supply management



Visit us: [Emerson.com/Aventics](https://www.emerson.com/Aventics)

Your local contact: [Emerson.com/contactus](https://www.emerson.com/contactus)



Emerson.com



Facebook.com/EmersonAutomationSolutions



LinkedIn.com/company/Emerson-Automation-Solutions



Twitter.com/EMR_Automation

An example configuration is depicted on the title page. The delivered product may thus vary from that in the illustration. Subject to change. This Document, as well as the data, specifications and other information set forth in it, are the exclusive property of AVENTICS GmbH. It may not be reproduced or given to third parties without its consent. Only use the AVENTICS products shown in industrial applications. Read the product documentation completely and carefully before using the product. Observe the applicable regulations and laws of the respective country. When integrating the product into applications, note the system manufacturer's specifications for safe use of the product. The data specified only serve to describe the product. No statements concerning a certain condition or suitability for a certain application can be derived from our information. The information given does not release the user from the obligation of own judgement and verification. It must be remembered that the products are subject to a natural process of wear and aging.

The Emerson logo is a trademark and service mark of Emerson Electric Co. Brand logotype are registered trademarks of one of the Emerson family of companies. All other marks are the property of their respective owners. © 2020 Emerson Electric Co. All rights reserved.
2020-12



CONSIDER IT SOLVED™